



## 81D Osborne Road, Newcastle Upon Tyne, NE2 2AN

**Offers Over £230,000**

Hive Estates presents this stunning two bedroom, two bathroom deluxe apartment in a prime development on Osborne Road, Jesmond.

Designed for modern living, the apartment boasts an open-plan kitchen with stylish wood cabinetry, black worktops, and integrated appliances, including an oven, hob, dishwasher, microwave, and fridge freezer. A breakfast bar adds a practical touch, complemented by cream floor tiles and a matching splashback. The spacious living and dining area features wood flooring and a large window, creating a bright and inviting atmosphere.

Both double bedrooms are fitted with soft grey carpets, with the master bedroom benefiting from an en-suite complete with a freestanding shower, wash basin, and WC, finished with sleek white wall tiles. The family bathroom offers a bath with an overhead shower, wash basin, and WC, elegantly styled with floor-to-ceiling cream tiles. Additional perks include secure gated parking and an exceptional location in the heart of Jesmond, offering easy access to vibrant cafés, bars, restaurants, and transport links.

**Lounge/Kitchen 17'8" x 14'1" (5.40 x 4.30)**

**Bedroom 1 10'2" x 10'4" (3.10 x 3.15)**

**Ensuite 6'6" x 4'3" (2.00 x 1.30)**

**Bedroom 2 13'7" x 8'6" (4.15 x 2.60)**

**Bathroom 5'6" x 10'7" (1.70 x 3.25)**

**Landing 9'2" x 6'1" (2.80 x 1.86)**

# Floor Plan

## First Floor

Approx. 49.8 sq. metres (535.5 sq. feet)

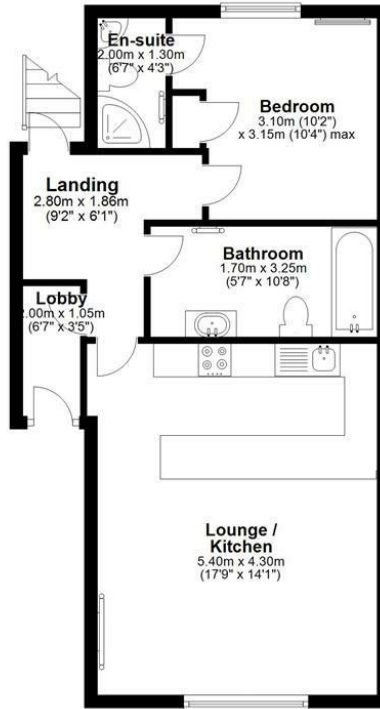

# Area Map

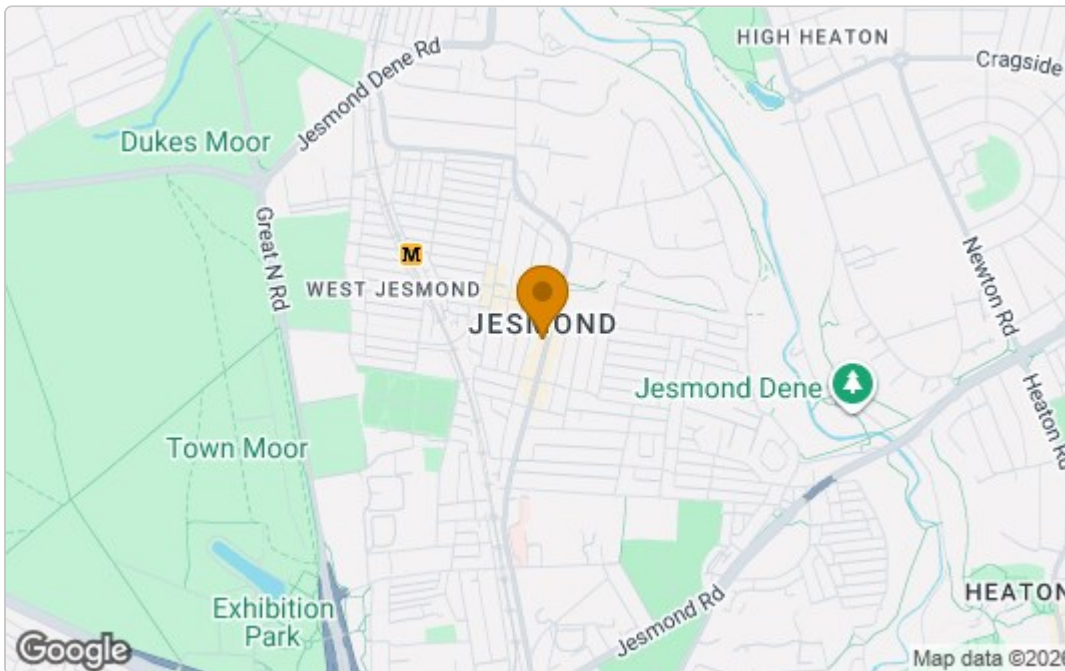

# Energy Efficiency Graph

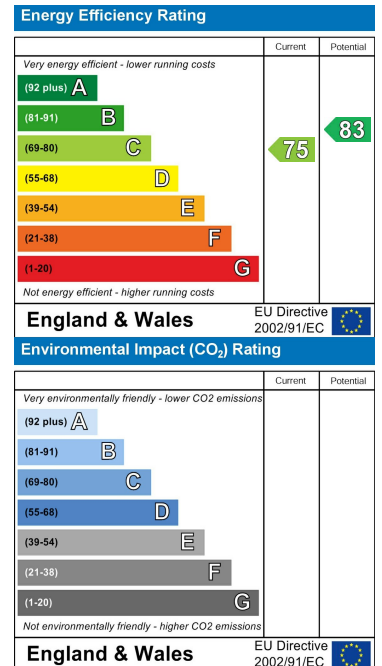

These particulars, whilst believed to be accurate are set out as a general outline only for guidance and do not constitute any part of an offer or contract. Intending purchasers should not rely on them as statements of representation of fact, but must satisfy themselves by inspection or otherwise as to their accuracy. No person in this firm's employment has the authority to make or give any representation or warranty in respect of the property.